

Camping du Chatelet

Entre lac et montagne



Nice and quiet, the "Camping du Chatelet" proposes you, pitches for your caravan or your tent, as well as nice and comfortable chalet or tent lodge for rent.

Its position, close to Sciez beach and marina, is ideal for bathing, fishing, sailing and motoring. Sports and leisure are fully accessible through close facilities and natural resources: yachting, golfing, rafting, paragliding, delta plane, horse riding, mountaineering, rambling...

Day trips from "Le Chatelet " are highly recommended to Thonon les Bains (7 kms), Evian (16 kms), Yvoire (5 kms), Geneva (25 kms), Annecy (70 kms) or Chamonix (80 kms) and many others exciting destinations, to discover the charms and the authenticity of our region and the nearby Switzerland.

The Camping du Chatelet provides quality services with recent equipments. Hot water is powered by solar energy and we especially care about ecological questions.

Since 2004 "[The green key](#)" label has been granted to the Camp as rewards for its endeavours.

Within the grounds you will find playgrounds for children, a multisports ground, a table-tennis setup, bowling grounds for "petanque", washing machines and a tumble dryer, as well as bread (in July and August), ice creams, beverages, ice, post cards, breakfast ...

A paying **Wifi** access is available on all the campsite.

We also have bicycle rental

Throughout the high season events are organised by the tourist offices of Sciez, Thonon and all local resort villages.

Leman country sights and " Camping du Chatelet " facilities will make your vacations unforgettable !

Open from April 5th to October 26th 2025.

138 pitches including 40 pitches for tent or caravan and 20 accommodations

Altitude : 385 m

GPS : 46.341056 N 6.396972 E

Camping du Chatelet

Entre lac et montagne



The «Camp du Chatelet » offers you defined placements of up to 95 square meters on the banks of the lake of Geneva, 300 meters from the marina and the beach of Sciez.

Within the grounds you will find a playing area for children, ping pong, washing machines as well as tourist information, postcards and fresh drinks.

We also have bikes for rent !

Our prices for **2025** are as following (including all hot water showers) :

All our pitches are on a flat and grassy ground and are equipped with electricity.

Rates 2025 per night



		High season Arrival : daily from 01/07 to 30/08	Low season Arrival : daily from 05/04 to 05/07 and from 30/08 to 25/10
	Package 2 pers + 1 car + caravan, tent or campervan	25.50 €	18.00 €
	10 A supply for European plugs	4.80 €	
	Extra person over 10 years old	7.00 €	5.60 €
	Child between 3 and 10 years old	4.10 €	3.00€
	Children under 3	Gratuit	
	Additional vehicle	4.20 €	3.00€
	Dog (1st and 2nd category prohibited)	5.00 €	4.00€
Touristic tax/night/person over 18		0.35 €	

We accept reservations for a stay of at least two nights, and in respect of this request, a down payment of 25 % of the amount of the stay with a credit card number and the expiry date, must then be joined to the enclosed booking slip.

You also can send an international money order or make a credit transfer.

The booking charge amounts to 10 €

The balance will have to be paid on arrival, for all the booked period.

Cancellation insurance: we recommend you to take out the "Neat camping" cancellation insurance .

The price is 5% of the amount of the stay. All conditions are available on our [website](#) .

For pitches, arrivals should be between 11 am. and 12.30 or between 4 pm. and 7.30 pm.

Departures should be before 11 am.

Reception is closed between 12.30 and 3 pm.

ACCOMMODATION RATES - CONFORT RANGE - SEASON 2025

Comfortable CHALETS from 2 to 6 persons with 2 all terrain bikes

Chalet 32 m² 2 bedrooms 4 persons + covered terrace

1 bedroom 1 double bed (140/190) • 1 bedroom 2 single beds (80/190) • 1 bathroom (shower, washbasin and toilets) • 1 main room with a fully equipped Kitchen Garden furniture • parasol • 2 sun loungers • 2 bikes available



MID AND HIGH SEASON 2 nights minimum - Arrival Saturday/Wednesday			LOW SEASON 2 nights minimum Arrival every day
From 24/05 to 31/05	From 05/07 to 23/08	From 23/08 to 05/09	From 05/04 to 24/05 From 31/05 to 05/07 From 07/09 to 26/10
567.00 €	1029.00 €	658.00 €	490€/week 203 €/week-end - 78€/night

Base rate for 4 people and a car

Chalet 32 m² – VIP - 2 bedrooms 4 persons + covered terrace

1 bedroom 1 double bed (160/200) • 1 bedroom 2 single beds (80/190) • 1 bathroom (shower, sink) • separate WC • 1 main room with fully equipped Kitchen with dishwasher, fridge freezer • garden furniture • parasol • 2 sun loungers • 2 bikes available

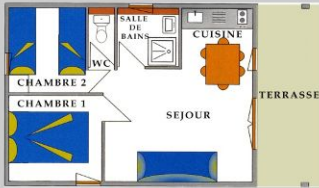

MID AND HIGH SEASON 2 nights minimum - Arrival Saturday			LOW SEASON 2 nights minimum Arrival every day
From 24/05 to 31/05	From 05/07 to 23/08	From 23/08 to 05/09	From 05/04 to 24/05 From 31/05 to 05/07 From 07/09 to 26/10
651.00 €	1183.00 €	756.00 €	567€/week 234 €/week-end - 90€/night

Base rate for 4 people and a car

Chalet 35 m² 2 bedrooms 4 persons + covered terrace

1 bedroom 1 double bed (140/190 or 160/200) • 1 bedroom 2 single beds (80/190) • 1 bathroom (shower, washbasin) • separated WC • 1 main room with a fully equipped kitchen • garden furniture • parasol • 2 sun loungers • 2 bikes available



MID AND HIGH SEASON 2 nights minimum - Arrival Saturday			LOW SEASON 2 nights minimum Arrival every day
From 24/05 to 31/05	From 05/07 to 23/08	From 23/08 to 05/09	From 05/04 to 24/05 From 31/05 to 05/07 From 07/09 to 26/10
693.00 €	1253.00 €	798.00 €	602 €/week 247 €/week-end - 95 €/night

Base rate for 4 people and a car

Chalet 35 m² 3 bedrooms 6 persons + covered terrace

3 chambres - 1 chambre 1 lit double (160/200) • 2 chambres avec 2 lits 80 x 190 • 1 salle d'eau (douche, lavabo) • toilettes séparées • 1 pièce principale avec cuisine toute équipée lave vaisselle • un salon de jardin • parasol • 2 chaises longues • 2 VTC à disposition



MID AND HIGH SEASON 2 nights minimum - Arrival Saturday			LOW SEASON 2 nights minimum Arrival every day
From 24/05 to 31/05	From 05/07 to 23/08	From 23/08 to 05/09	From 05/04 to 24/05 From 31/05 to 05/07 From 07/09 to 26/10
756.00 €	1372.00 €	875.00 €	658 €/week 270 €/week-end - 104 €/night

Base rate for 6 people and a car

Chalet 40 m² 3 bedrooms 6 persons + covered terrace

bedroom 1 double bed (160/200) • 2 bedrooms 2 single beds (80/190) • 1 bathroom (shower, washbasin) • separated WC • 1 main room with a fully equipped kitchen Garden furniture • parasol • 2 sun loungers • 2 bikes available



MID AND HIGH SEASON 2 nights minimum - Arrival Saturday			LOW SEASON 2 nights minimum Arrival every day
From 24/05 to 31/05	From 05/07 to 23/08	From 23/08 to 05/09	From 05/04 to 24/05 From 31/05 to 05/07 From 07/09 to 26/10
910.00 €	1645.00 €	1050.00 €	791 €/week 325 €/week-end - 125 €/night

Base rate for 6 people and a car

Chalet 35 m² PMR (for disabled person) 2 bedrooms 4 persons + covered terrace

1 bedroom 1 double bed (160/200) • 1 bedroom with 2 upper beds (80/190) • 1 bathroom (Italian style shower, washbasin and toilets) • 1 main room with a fully equipped kitchen Garden furniture • parasol • 2 sun loungers • 2 bikes available



MID AND HIGH SEASON 2 nights minimum - Arrival Saturday			LOW SEASON 2 nights minimum Arrival every day
From 24/05 to 31/05	From 05/07 to 23/08	From 23/08 to 05/09	From 05/04 to 24/05 From 31/05 to 05/07 From 07/09 to 26/10
651.00 €	1183.00 €	756.00 €	567€/week 234 €/week-end - 90€/night

Base rate for 4 people and a car

Mobilhome 30 m² 2 bedrooms 4 people + covered terrace

1 bedroom 1 double bed (140/190) • 1 bedroom 2 single beds (80/190) • 1 bathroom (shower, sink) • separate WC • 1 main room with fully equipped kitchen with fridge and freezer • Garden furniture • 2 sun loungers • 2 bikes available



Several type of mobilhome, non-contractual photos

MID AND HIGH SEASON 2 nights minimum Arrival Saturday-Wednesday			LOW SEASON 2 nights minimum Arrival every day
From 24/05 to 31/05	From 05/07 to 23/08	From 23/08 to 05/09	From 05/04 to 24/05 From 31/05 to 05/07 From 07/09 to 26/10
567.00 €	1029.00 €	658.00 €	490/week 203 €/week-end - 78€/night

Base rate for 4 people and a car

Chalet 21 m² 1 bedroom 2 persons + covered terrace

1 bedroom 1 double bed (140/190) • 1 bathroom (shower, washbasin and toilets) • 1 main room with a fully equipped kitchen Garden furniture • parasol • 2 sun loungers • 2 bikes available

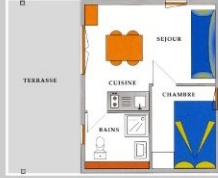

MID AND HIGH SEASON 2 nights minimum - Arrival Saturday			LOW SEASON 2 nights minimum Arrival every day
From 24/05 to 31/05	From 05/07 to 23/08	From 23/08 to 05/09	From 05/04 to 24/05 From 31/05 to 05/07 From 07/09 to 26/10
476.00 €	854.00 €	546.00 €	413€/semaine 169 €/week-end - 65€/nuit

Base rate for 2 people and a car

ACCOMMODATION RATES - "ECO" RANGE - SEASON 2025

Tents lodge, chalets without sanitary facilities

Tent lodge 15m² 2 bedrooms 4 persons

2 bedrooms 1 bedroom with 1 double bed (140/190) - one bedroom with 2 pull-out beds 70 x 190 - kitchen with electric hob, mini oven and fridge no bathroom facilities

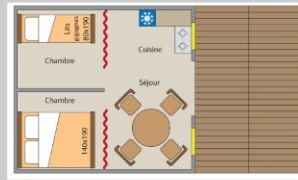

MID AND HIGH SEASON 2 nights minimum - Arrival every day			LOW SEASON 2 nights minimum Arrival every day
From 24/05 to 31/05	From 05/07 to 23/08	From 23/08 to 05/09	From 05/04 to 24/05 From 31/05 to 05/07 From 07/09 to 26/10
49 €/night	92 €/night	55 €/night	287€/week 120 €/week-end - 46€/night

Rate for 4 people and one car

Chalet 12 m² 1 room 2 persons + balcony

a comfortable 140/190 folding bed - a pretty kitchenette with hot and cold water sink - garden furniture no sanitary facilities

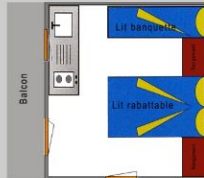

MID AND HIGH SEASON 2 nights minimum - Arrival every day			LOW SEASON 2 nights minimum Arrival every day
From 24/05 to 31/05	From 05/07 to 23/08	From 23/08 to 05/09	From 05/04 to 24/05 From 31/05 to 05/07 From 07/09 to 26/10
49 €/night	90 €/night	58 €/night	301€/semaine 125 €/week-end - 48€/nuit

Rate for 2 people and one car

Chalet 7 m², 2 persons without sanitary facilities

a "BZ" folding bed 140 x 190 cm • an outdoor kitchenette with fridge, no sink • garden furniture



MID AND HIGH SEASON 2 nights minimum - Arrival every day			LOW SEASON 2 nights minimum Arrival every day
From 24/05 to 31/05	From 05/07 to 23/08	From 23/08 to 05/09	From 05/04 to 24/05 From 31/05 to 05/07 From 07/09 to 26/10
37 €/night	66 €/night	42 €/night	224€/week 91 €/week-end - 35€/night

Rate for 2 people and one car

Additional services

Rates 2025	From 05/07 to 30/08	From 05/04 to 05/07 From 30/08 to 26/10
Additional persons more than 10 years old	49.00 €	39.20 €
Child from 3 to 10 years old	28.70 €	21.00 €
Child less than 3 years old		Free
Dog (1st and 2nd category prohibited)	29.40 €	21.00 €
Extra vehicle		49.00 €
Touristic tax / night / person more than 18 years old		0.35 €
Sheets rental	Double bed 12.00 €	Single bed 10.00 €
Reservation fee		14.00 €
Cancellation insurance « NEAT CAMPING »	5% of the rental amount	

BOOKING FORM

Name : First name :

Address :

Zip Code : Town : Country :

Phone number : E-mail :

Total number of occupants (accommodation or pitch):

	Name	First name	Date of birth
1			
2			
3			
4			
5			
6			

Pets: Yes No Number (2 maximum) : (1st and 2nd category not allowed)

Accommodation: Chalet 35 m² 2 bedrooms Chalet 35 m² 3 bedrooms Chalet 40 m² 3 bedrooms
 Chalet 35 m² PMR 2 bedrooms Chalet 32 m² 2 bedrooms Chalet 21 m² 1 bedroom
 Tent lodge 15 m² 2 bedrooms, without bathroom
 Chalet 12 m² without bathroom Chalet 6 m² without bathroom

Pitch: Tent Caravan Camping car Dimensions :

Electricity 10 A : Yes No

Date of stay (From Saturday to Saturday in July and august for the accommodations)

Arrival : **Departure :**

Down payment:

We require a down payment of 25% of the total cost of stay.

Cancellation insurance, 5% of the amount of the stay, excluding booking fees and tourist tax.

On receipt of your payment, we will send you a confirmation and receipt.

Down payment	=
Booking fee (8 € for pitches/12 € for accommodation)	=
Cancellation insurance	=

TOTAL	=

Credit card (Visa, MasterCard, EuroCard, Maestro)

N° card : □□□□ □□□□ □□□□ □□□□ Date of expiration : ___/___/____ Cryptogram : □□□

Comments :

Date :

Signature :

Rental terms and conditions

All rentals shall be registered to one person and are not transferable under any circumstances. Anybody staying at the campsite must respect the rules and regulations displayed at reception. The number of persons occupying accommodation or a camping pitch cannot exceed the maximum capacity for the accommodation or 6 persons.

The rental is only effective once we have received the accommodation booking form, an initial payment, the booking fees and (if appropriate) cancellation insurance and **once you have received written confirmation from us.**

For accommodation, the balance of the rental must be paid at least 30 days prior to arrival. If the balance has not been paid 30 days prior to arrival, the contract will become null and void, the owner will keep the initial payment and be able to dispose of his/her property as s/he sees fit.

For camping pitches, the entire sum for the duration of the booking is payable upon arrival.

There will be no discount in the event of late arrival or early departure.

In the absence of notification from the camper stating that s/he has been forced to delay the date of arrival, the accommodation or camping pitch will become available again at midday on the day following the date of arrival stated on the rental agreement and the entire amount of rental will still be owed.

Cancellation. Written confirmation (letter or email) is required for all cancellations.

In the event of cancellation, the following will be retained or remain payable by you:

- The booking and insurance fees
- As compensation for breach of contract:
 - A sum equal to the initial payment, if you cancel more than 30 days prior to the anticipated date of arrival,
 - A sum equal to the total rent, if you cancel less than 31 days prior to the anticipated date of arrival, or if you fail to appear on that date.

If you have taken out the cancellation insurance "Neat camping", the costs of breach of contract will be covered providing certain conditions are met. You can obtain details of the terms and conditions from :

<https://neat-documents.b-cdn.net/camping/Formule-flex/Anglais/Notice-Flex-English.pdf>

Deposit: For accommodation, a deposit of **€ 300** must be paid when taking possession of the property. It will be reimbursed 10 days at the latest after the day of departure, minus the costs of any repairs to the premises.

Inventory and inspection of fixtures and fittings: An inventory of the contents and equipment in the accommodation will be conducted jointly with the owner or his representative both on the day of arrival and day of departure. Any complaints about the inventory or the property must be made within 24 hours of the date of arrival. The property leased includes the furniture, crockery and bedding in accordance with the description provided at the time of booking. The tenant shall be responsible for the items recorded on the inventory and will be obliged to pay for any damaged items and, if necessary, for their repair. The tenant must indicate any damage or breakage occurring during his/her stay.

The tenant is responsible for cleaning the accommodation. At the end of the rental period, the interior of the accommodation and the immediate vicinity must be clean and in good condition. Failure to comply with this will result in **€ 80 being deducted from the deposit to cover cleaning costs.**

Arrival and departure times

For accommodation in July/August, tenants will arrive on Saturday between 4 pm and 7.30 pm and depart on Saturday before 10 am.

At other times of the year, tenants may arrive at any time for a minimum 2-night stay

For camping pitches in July/August, tenants will arrive between 11 am and 12.30 pm or between 3 pm and 7.30 pm

Reception is closed from 12.30 pm to 3 pm

By signing the contract, the tenant indicates that s/he has read, is fully cognizant of and accepts the rental terms and conditions.

In accordance with the provisions of Article L 612-1 of the French Consumer Code, every customer of the campsite has the right to have recourse free of charge to a consumer mediator with a view to amicably resolving a dispute between him and his client. the operator of the land. The contact details of the consumer mediator that the customer can enter are as follows: CM2C ,14 rue Saint Jean 75017 Paris - Email : cm2c@cm2c.net - Internet : <https://cm2c.net/>